

PowerTrac PRN 1250 - 0200 LH, Preloaded, SGT Only

Call 800-321-7800 or visit us online at www.nookindustries.com to configure and order your PowerTrac PRN 1250 - 0200 LH, Preloaded, SGT Only

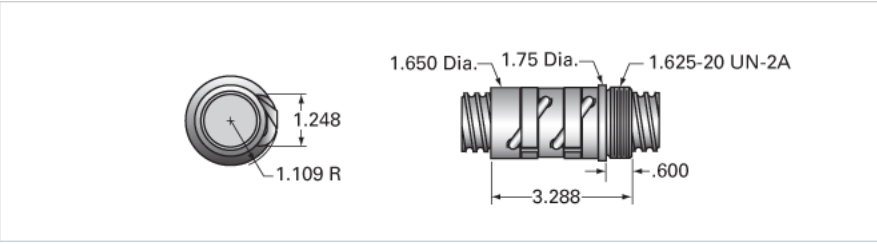

Product Info	
Ball Nut Number	PRN10193
Thread Direction	LH
Details	
Ball Circle Diameter [in]	1.250
Lead [in]	0.200
Nominal Ball Diameter [in]	0.125
Root diameter [in]	1.115
Forces and Torques	
Torque to Raise 1 lb. [in-lb]	0.035
Flange Part Numbers	
Flange Part Number	-
Wiper Part Numbers	
Wiper Kit Part Number	ELASTOMER
Weight	
Nut Weight [lb]	1.80
Performance Specifications	
Maximum Adjustable Preload [lb]	
Spring Rate x 10 ⁶ [lb./in.]	4.25
Dynamic Load [lb]	1668
Static Load [lb]	17344