

PowerAC 1"-4 TA w/Bronze Nut

Call 800-321-7800 or visit us online at www.nookindustries.com to configure and order your PowerAC 1"-4 TA w/Bronze Nut today!

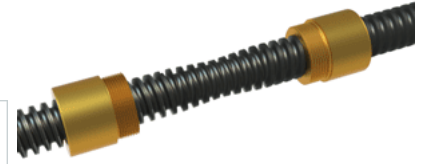
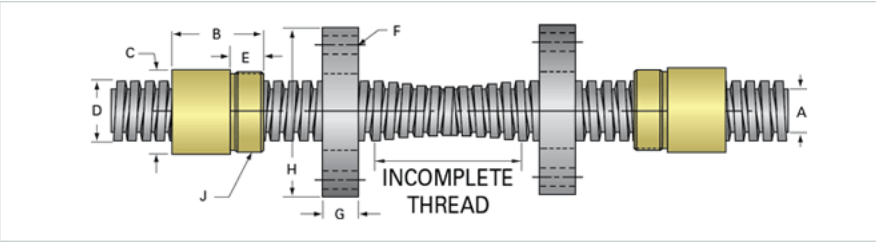

Rolled Inch Twin-Lead Acme Screw (Twin-Lead Screw)Product Info

Screw Code	104 TA
Screw Direction	RH/LH
Screw Material	4140 Series

(Twin-Lead Screw)Details

Lead [in]	0.250
Starts	1
Pitch [in]	0.250
Turns Per Inch	4
Threads per Inch	4
Thread Code	104
Form	2C
End Code for Types 1,2,3,5 [* Journals may show tracings of the thread]	17
End Code for Type 4 [* Journals may show tracings of the thread]	10

(Twin-Lead Screw)Dimensions

A - Root Diameter Minimum [in]	0.698
D - Nominal Rod Diameter [in]	1.000
Incomplete Overlapping Thread Length [in]	2.50
Maximum Overall Length [in]	72
Maximum Useable LH & RH Thread [in]	34.75

(Twin-Lead Screw)Weight

Weight Per Foot [lb]	2.22
----------------------	------

(Twin-Lead Screw)Part Numbers

36" Part Number	
72" Part Number	
144" Part Number	

(Twin-Lead Screw)Performance Specifications

Lead Accuracy +/- [in/in]	0.0003
---------------------------	--------

Inch Acme Nut with Optional Flange

(Nut)Product Info

Part Number	80104
Thread Direction	LH
Type	Bronze

(Nut)Details

Lead [in]	0.250
Starts	1
Pitch [in]	0.250
Turns Per Inch	4
Lash (Maximum Axial) [in]	0.010
Nominal Rod Diameter [in]	1.000
Threads per Inch	4
Thread Code	104
Form	2C

(Nut)Dimensions

B [in]	1.50
C [in]	1.50
E [in]	0.50
F (n) Dia. [in]	(4) .266
F BCD [in]	2.260
G [in]	0.52
H [in]	2.76
J [in]	1.375-16

(Nut)Forces and Torques

Torque to Raise 1 lb. [in-lb]	0.105
-------------------------------	-------

(Nut)Flange Part Numbers

Flange No-Lash Part Number	73275
Flange Part Number	FLG8281

(Nut)Weight

Flange Weight [lb]	0.85
Nut Weight [lb]	0.52

(Nut)Performance Specifications	
Efficiency [%]	38
Lead Accuracy +/- [in/in]	0.0003
Dynamic Load Capacity [lb]	5000
Static Load Capacity [lb]	16000
(Nut on Other Side)Product Info	
Part Number	20104
Thread Direction	RH
Type	Bronze
(Nut on Other Side)Details	
Lead [in]	0.250
Starts	1
Pitch [in]	0.250
Turns Per Inch	4
Lash (Maximum Axial) [in]	0.010
Nominal Rod Diameter [in]	1.000
Threads per Inch	4
Thread Code	104
Form	2C
(Nut on Other Side)Dimensions	
B [in]	1.50
C [in]	1.50
E [in]	0.50
F (n) Dia. [in]	(4) .266
F BCD [in]	2.260
G [in]	0.52
H [in]	2.76
J [in]	1.375-16
(Nut on Other Side)Forces and Torques	
Torque to Raise 1 lb. [in-lb]	0.105
(Nut on Other Side)Flange Part Numbers	
Flange No-Lash Part Number	73275
Flange Part Number	FLG8281
(Nut on Other Side)Weight	
Flange Weight [lb]	0.85
Nut Weight [lb]	0.52
(Nut on Other Side)Performance Specifications	
Efficiency [%]	38
Lead Accuracy +/- [in/in]	0.0003
Dynamic Load Capacity [lb]	5000
Static Load Capacity [lb]	16000