

## PowerTrac MRT 40 x 40 RH with MBN Ball Nut

Call 800-321-7800 or visit us online at [www.nookindustries.com](http://www.nookindustries.com) to configure and order your PowerTrac MRT 40 x 40 RH with MBN Ball Nut today!

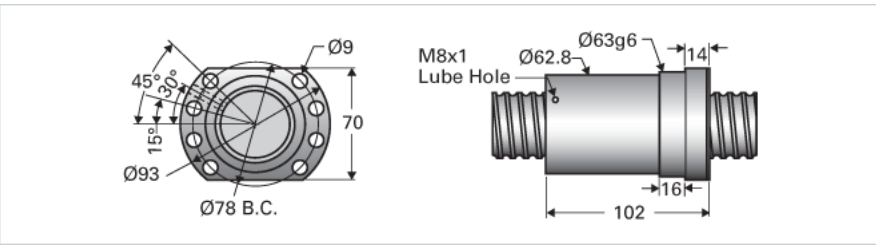

### Metric Ball Screw

#### (Screw)Product Info

Screw Code	40x40 MRT RA
Precision	MRT
Screw Material	4150
Thread Direction	RH

#### (Screw)Details

Screw Part Number	40x40 MRT
Ball Circle Diameter [mm]	40.28
Lead [mm]	40
Root Diameter [mm]	33.79
End Code for Types 1,2,3,5 [* Journals may show tracings of the thread]	30
End Code for Type 4 [* Journals may show tracings of the thread]	19

#### (Screw)Weight

Screw Weight [g/m]	8315
--------------------	------

#### (Screw)Performance Specifications

Lead Accuracy +/- [#956;m/300mm]	100
----------------------------------	-----

### Metric Ball Nut, for MRT, No Preload, Standard Accuracy, MBN

#### (Nut)Product Info

Ball Nut Number	MPN10429
Thread Direction	RH

#### (Nut)Details

Ball Circle Diameter [mm]	40.28
Lead [mm]	40
Nominal Ball Diameter [mm]	6.35
Root Diameter [mm]	33.79

#### (Nut)Forces and Torques

Torque to Raise 1 kN [Nm]	7.08
---------------------------	------

#### (Nut)Flange Part Numbers

Flange Part Number	INTEGRAL
--------------------	----------

#### (Nut)Wiper Part Numbers

Wiper Kit Part Number	PLASTIC
-----------------------	---------

#### (Nut)Weight

Nut Weight [g]	1.56
----------------	------

#### (Nut)Performance Specifications

Lead Accuracy +/- [#956;m/300mm]	100
Dynamic Load Ca [kN]	75.3
Static Load Coa [kN]	121.4