

PowerTrac 2500 - 0250 SRT RA, with SAR Ball Nut, Adjustable

Call 800-321-7800 or visit us online at www.nookindustries.com to configure and order your PowerTrac 2500 - 0250 SRT RA, with SAR Ball Nut,

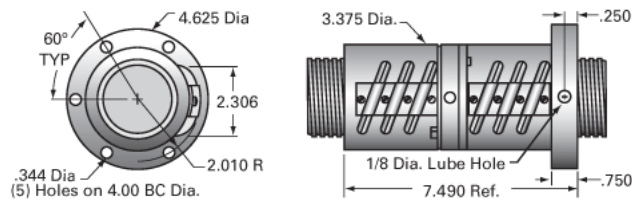

Inch Ball Screw

(Screw)Product Info

| | |
|------------------|------------------|
| Screw Code | 2500-0250 SRT RA |
| Precision | SRT |
| Screw Material | 4150 |
| Thread Direction | RH |

(Screw)Details

| | |
|---|-------|
| Ball Circle Diameter [in] | 2.500 |
| Lead [in] | 0.250 |
| Root Diameter [in] | 2.320 |
| End Code for Types 1,2,3,5 [* Journals may show tracings of the thread] | 50 |
| End Code for Type 4 [* Journals may show tracings of the thread] | 32 |

(Screw)Performance Specifications

| | |
|-----------------------------|--------|
| Lead Accuracy +/- [in./ft.] | 0.0040 |
|-----------------------------|--------|

(Screw)Part Numbers

| | |
|--------------------|---------|
| 2 ft. Part Number | |
| 4 ft. Part Number | SRT3255 |
| 6 ft. Part Number | |
| 8 ft. Part Number | SRT3256 |
| 12 ft. Part Number | SRT3257 |
| 16 ft. Part Number | SRT0442 |
| 20 ft. Part Number | SRT0606 |

(Screw)Weight

| | |
|------------------------|-------|
| Screw Weight [lb./ft.] | 15.45 |
|------------------------|-------|

Inch Ball Nut, for SRT, Standard Accuracy, Preloaded, Adjustable, SAR

(Nut)Product Info

| | |
|------------------|---------|
| Ball Nut Number | SAR3242 |
| Thread Direction | RH |

(Nut)Details

| | |
|----------------------------|-------|
| Ball Circle Diameter [in] | 2.500 |
| Lead [in] | 0.250 |
| Nominal Ball Diameter [in] | 0.156 |
| Root diameter [in] | 2.320 |

(Nut)Forces and Torques

| | |
|-------------------------------|-------|
| Torque to Raise 1 lb. [in-lb] | 0.044 |
|-------------------------------|-------|

(Nut)Flange Part Numbers

| | |
|--------------------|----------|
| Flange Part Number | INTEGRAL |
|--------------------|----------|

(Nut)Wiper Part Numbers

| | |
|-----------------------|-------|
| Wiper Kit Part Number | BRUSH |
|-----------------------|-------|

(Nut)Weight

| | |
|-----------------|------|
| Nut Weight [lb] | 9.90 |
|-----------------|------|

(Nut)Performance Specifications

| | |
|---|-------|
| Lead Accuracy +/- [in./ft.] | 0.004 |
| Maximum Adjustable Preload [lb] | 1895 |
| Spring Rate x 10 ⁶ [lb./in.] | |
| Dynamic Load [lb] | 6315 |
| Static Load [lb] | 81938 |