

## PowerTrac 0631 - 0500 SRT RA, with SBN Ball Nut, Double Circuit

Call 800-321-7800 or visit us online at [www.nookindustries.com](http://www.nookindustries.com) to configure and order your PowerTrac 0631 - 0500 SRT RA, with SBN Ball Nut, Double

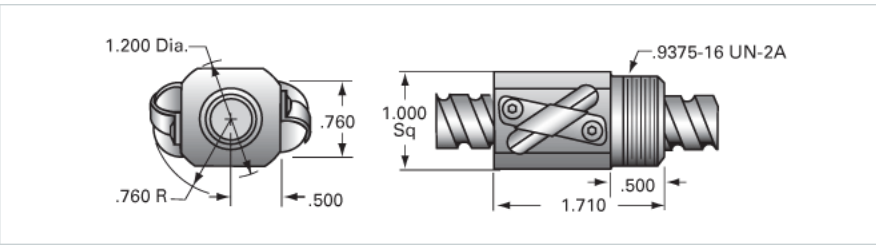

|   |                  |
|---|------------------|
| <b>Inch Ball Screw</b>  |                  |
| <b>(Screw)Product Info</b>  |                  |
| Screw Code  | 0631-0500 SRT RA |
| Precision   | SRT              |
| Screw Material  | 4150             |
| Thread Direction  | RH               |
| <b>(Screw)Details</b>   |                  |
| Ball Circle Diameter [in]   | 0.631            |
| Lead [in]   | 0.500            |
| Root Diameter [in]  | 0.500            |
| End Code for Types 1,2,3,5 [* Journals may show tracings of the thread]     | 12               |
| End Code for Type 4 [* Journals may show tracings of the thread]            | 8                |
| <b>(Screw)Performance Specifications</b>                                    |                  |
| Lead Accuracy +/- [in./ft.]   | 0.0040           |
| <b>(Screw)Part Numbers</b>  |                  |
| 2 ft. Part Number   | SRT6524          |
| 4 ft. Part Number   | SRT6548          |
| 6 ft. Part Number   | SRT6572          |
| 8 ft. Part Number   |                  |
| 12 ft. Part Number  |                  |
| 16 ft. Part Number  |                  |
| 20 ft. Part Number  |                  |
| <b>(Screw)Weight</b>  |                  |
| Screw Weight [lb./ft.]  | 0.82             |
| <b>Inch Ball Nut, for SRT, Standard Accuracy, No Preload, SBN, Standard</b> |                  |
| <b>(Nut)Product Info</b>  |                  |
| Ball Nut Number   | SBN10113         |
| Thread Direction  | RH               |
| <b>(Nut)Details</b>   |                  |
| Ball Circle Diameter [in]   | 0.631            |
| Lead [in]   | 0.500            |
| Nominal Ball Diameter [in]  | 0.125            |
| Root diameter [in]  | 0.500            |
| <b>(Nut)Dimensions</b>  |                  |
| A [in]  |                  |
| <b>(Nut)Forces and Torques</b>  |                  |
| Torque to Raise 1 lb. [in-lb]   | 0.088            |
| <b>(Nut)Flange Part Numbers</b>   |                  |
| Flange Part Number  | FLG7570          |
| <b>(Nut)Wiper Part Numbers</b>  |                  |
| Wiper Kit Part Number   | -                |
| Wiper Kit Felt Part Number  |                  |
| <b>(Nut)Weight</b>  |                  |
| Nut Weight [lb]   | 0.27             |
| <b>(Nut)Performance Specifications</b>                                      |                  |
| Lead Accuracy +/- [in./ft.]   | 0.004            |
| Maximum Adjustable Preload [lb]   |                  |
| Spring Rate x 10 <sup>6</sup> [lb./in.]                                     |                  |
| Dynamic Load [lb]   | 960              |
| Static Load [lb]  | 5565             |