

NRS SF 2W 39x20 w/Wiper

Call 800-321-7800 or visit us online at www.nookindustries.com to configure and order your NRS SF 2W 39x20 w/Wiper today!

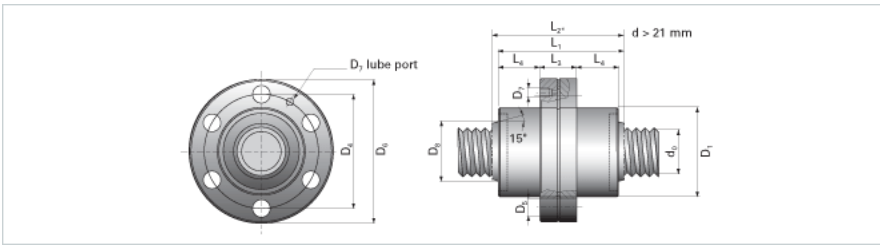
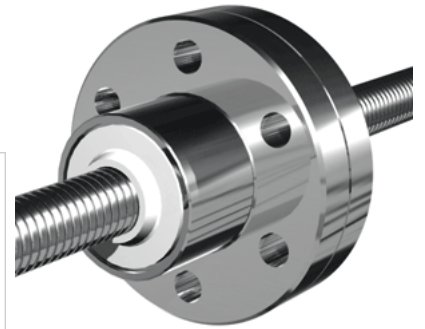

Product Info

Nominal Rod Diameter [mm] 39

Details

Lead [mm] 20

End Code for Types 1,2,3,5 [* Journals may show tracings of the thread] 35

Dimensions

D1 [mm] 80

D4 [mm] 102

D6 [mm] 124

D7 M6

D8 [mm] 54

L1 [mm] 110

L2 [mm] 126

L3 [mm] 38.5

L4 [mm] 33.5

n x D5 6x11

Performance Specifications

Dynamic Load Ratings Ca [kN] 86.70

Static Load Ratings Coa [kN] 109.20