

## Type 2L, End Code 50

Call 800-321-7800 or visit us online at [www.nookindustries.com](http://www.nookindustries.com) to configure and order your Type 2L, End Code 50 today!

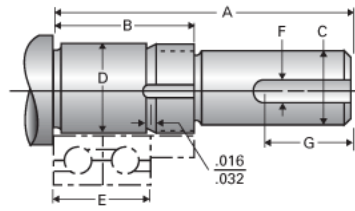

### Product Info

Nominal Bearing Journal Size 50

### Dimensions

C Maximum [in]	1.750
C Minimum [in]	1.749
D Maximum [in]	1.9689
D Minimum [in]	1.9684
F [in]	N/A
G [in]	N/A
Typical Journal for Single Bearing A [in]	5.62
Typical Journal for Single Bearing B [in]	2.75
Typical Journal for Single Bearing E [in]	2.126
Lock Nut	N-10
Lock Washer	W-10