

## Type 2L, End Code 20

Call 800-321-7800 or visit us online at [www.nookindustries.com](http://www.nookindustries.com) to configure and order your Type 2L, End Code 20 today!

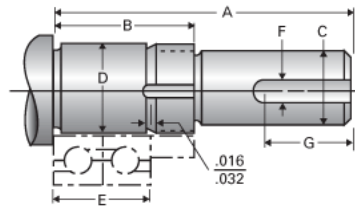

### Product Info

Nominal Bearing Journal Size 20

### Dimensions

C Maximum [in]	0.625
C Minimum [in]	0.624
D Maximum [in]	0.7877
D Minimum [in]	0.7873
F [in]	N/A
G [in]	N/A
Typical Journal for Single Bearing A [in]	2.93
Typical Journal for Single Bearing B [in]	1.61
Typical Journal for Single Bearing E [in]	1.102
Lock Nut	N-04
Lock Washer	W-04