

Type 2L, End Code 17

Call 800-321-7800 or visit us online at www.nookindustries.com to configure and order your Type 2L, End Code 17 today!

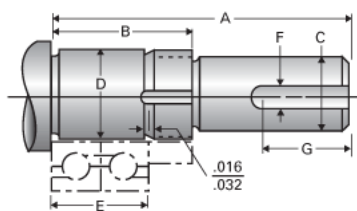

Product Info

Nominal Bearing Journal Size 17

Dimensions

| | |
|---|--------|
| C Maximum [in] | 0.500 |
| C Minimum [in] | 0.499 |
| D Maximum [in] | 0.6695 |
| D Minimum [in] | 0.6692 |
| F [in] | N/A |
| G [in] | N/A |
| Typical Journal for Single Bearing A [in] | 2.71 |
| Typical Journal for Single Bearing B [in] | 1.39 |
| Typical Journal for Single Bearing E [in] | 0.944 |
| Lock Nut | N-3 |
| Lock Washer | W-03 |