

Type 2L, End Code 9

Call 800-321-7800 or visit us online at www.nookindustries.com to configure and order your Type 2L, End Code 9 today!

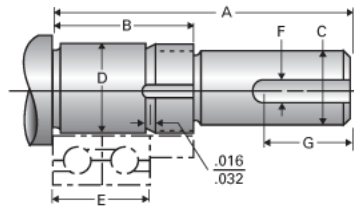

Product Info

Nominal Bearing Journal Size 9

Dimensions

| | |
|---|---------|
| C Maximum [in] | 0.250 |
| C Minimum [in] | 0.249 |
| D Maximum [in] | 0.3544 |
| D Minimum [in] | 0.3541 |
| F [in] | N/A |
| G [in] | N/A |
| Typical Journal for Single Bearing A [in] | 1.69 |
| Typical Journal for Single Bearing B [in] | 1.04 |
| Typical Journal for Single Bearing E [in] | 0.630 |
| Lock Nut | 5/16-24 |
| Lock Washer | N/A |