

## Type 2L, End Code 7

Call 800-321-7800 or visit us online at [www.nookindustries.com](http://www.nookindustries.com) to configure and order your Type 2L, End Code 7 today!

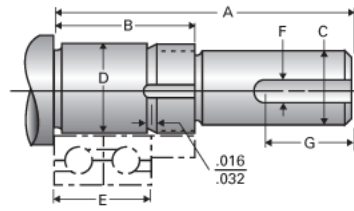

### Product Info

Nominal Bearing Journal Size 7

### Dimensions

C Maximum [in]	0.187
C Minimum [in]	0.186
D Maximum [in]	0.2757
D Minimum [in]	0.2754
F [in]	N/A
G [in]	N/A
Typical Journal for Single Bearing A [in]	1.41
Typical Journal for Single Bearing B [in]	0.93
Typical Journal for Single Bearing E [in]	0.552
Lock Nut	1/4-20
Lock Washer	N/A