

## PowerTrac SBN 6000 - 1000 RH, Internal Return

Call 800-321-7800 or visit us online at [www.nookindustries.com](http://www.nookindustries.com) to configure and order your PowerTrac SBN 6000 - 1000 RH, Internal Return today!

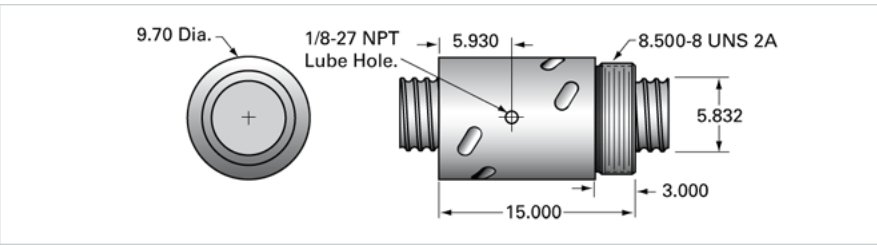

Product Info	
Ball Nut Number	SBN10438
Thread Direction	RH
Details	
Ball Circle Diameter [in]	6.000
Lead [in]	1.000
Nominal Ball Diameter [in]	1.514
Root diameter [in]	5.232
Dimensions	
A [in]	
Forces and Torques	
Torque to Raise 1 lb. [in-lb]	0.177
Flange Part Numbers	
Flange Part Number	FLG10437
Wiper Part Numbers	
Wiper Kit Part Number	WKP10441
Wiper Kit Felt Part Number	
Weight	
Nut Weight [lb]	170.00
Performance Specifications	
Lead Accuracy +/- [in./ft.]	0.002
Maximum Adjustable Preload [lb]	
Spring Rate x 10 <sup>6</sup> [lb./in.]	
Dynamic Load [lb]	115507
Static Load [lb]	443548