

## PowerTrac PRN 1250 - 0500 RH, Preloaded

Call 800-321-7800 or visit us online at [www.nookindustries.com](http://www.nookindustries.com) to configure and order your PowerTrac PRN 1250 - 0500 RH, Preloaded today!

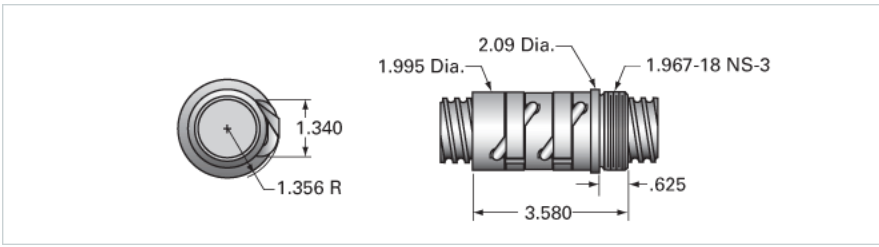

### Product Info

Ball Nut Number	PRN10087
Thread Direction	RH

### Details

Ball Circle Diameter [in]	1.250
Lead [in]	0.500
Nominal Ball Diameter [in]	0.188
Root diameter [in]	1.050

### Forces and Torques

Torque to Raise 1 lb. [in-lb]	0.088
-------------------------------	-------

### Flange Part Numbers

Flange Part Number	FLG7572
--------------------	---------

### Wiper Part Numbers

Wiper Kit Part Number	ELASTOMER
-----------------------	-----------

### Weight

Nut Weight [lb]	2.75
-----------------	------

### Performance Specifications

Maximum Adjustable Preload [lb]	
Spring Rate x 10 <sup>6</sup> [lb./in.]	4.25
Dynamic Load [lb]	1765
Static Load [lb]	11080